



STEALTH HD REMOTE

High Performance Audio

STEALTH HD REMOTE PAIRING & BATTERY CHANGE

To pair an RF remote with a sound bar it first must be a remote compatible version.

The Stealth HD version bars are the ONLY bars with remote compatibility.

You can tell this version by watching the LED indicator when the bar is turned on.

The LED will flash Green then Blue.

No Green flash = not remote compatible bar.

To pair the remote to a compatible bar

Remote Pairing

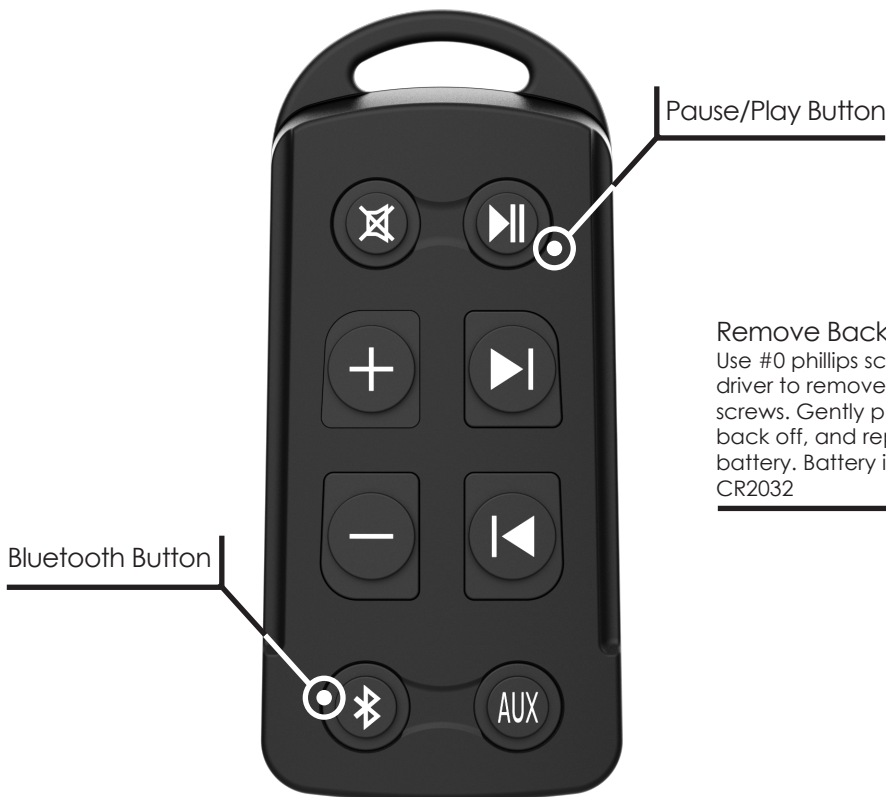

Battery Changing



1. Turn the bar off on the front of the unit by pressing and holding the power button for three seconds.
2. Then on the remote, press and hold the pause/play button and the Bluetooth buttons simultaneously (top right and bottom left buttons).
3. Power the Sound bar on while continuing to hold both buttons (about 3 seconds). The bar will flash rapid green then go to blue. You are now programmed please check function and enjoy your product. You can purchase replacement remotes and remote holders if needed.