

AR-5 Ranger Crew

5 Speaker Audio Roof with Lighting

Installation Guide

AR-5 Ranger Crew



Wet Sounds, Inc.
www.wetsounds.com
877-938-7757

2975 Louise Street
Rosenberg, Texas 77471 USA

Wet Sounds, Inc. is not affiliated with or in any way associated with Polaris Industries or any other person, entity, product or organization. Reference in this document to any specific commercial product, process, or service, or the use of any trade, firm or corporation name is for the information and convenience of the public, and does not constitute endorsement or recommendation by Wet Sounds, Inc.

© 2022 Wet Sounds, Inc. All Rights Reserved. WET SOUNDS and associated logos where applicable are registered trademarks of Wet Sounds Corporation in the United States and/or other countries. All other trademarks are the property of their respective owners.

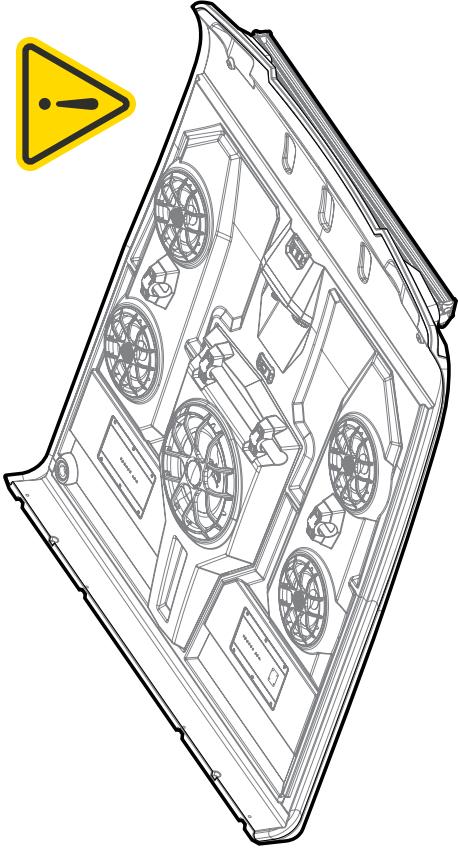
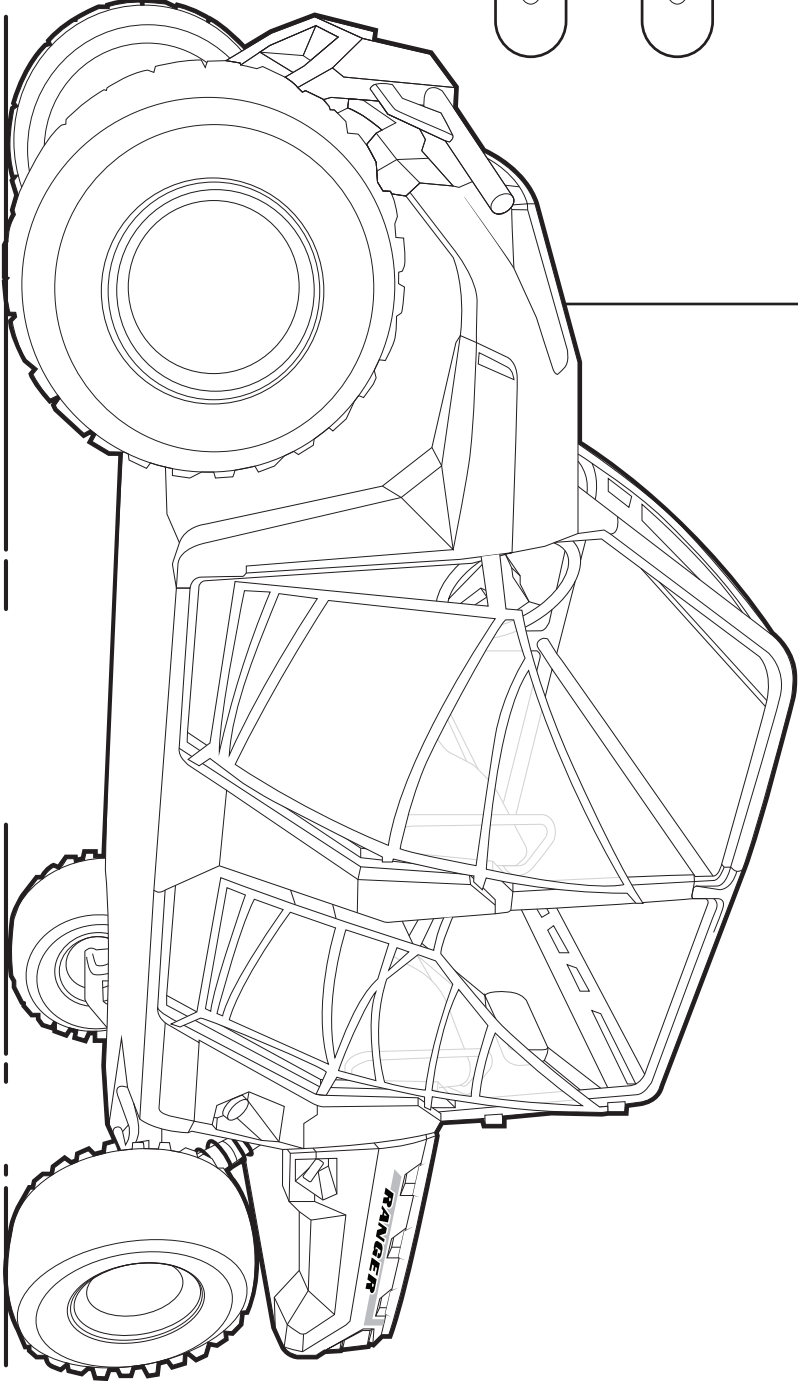
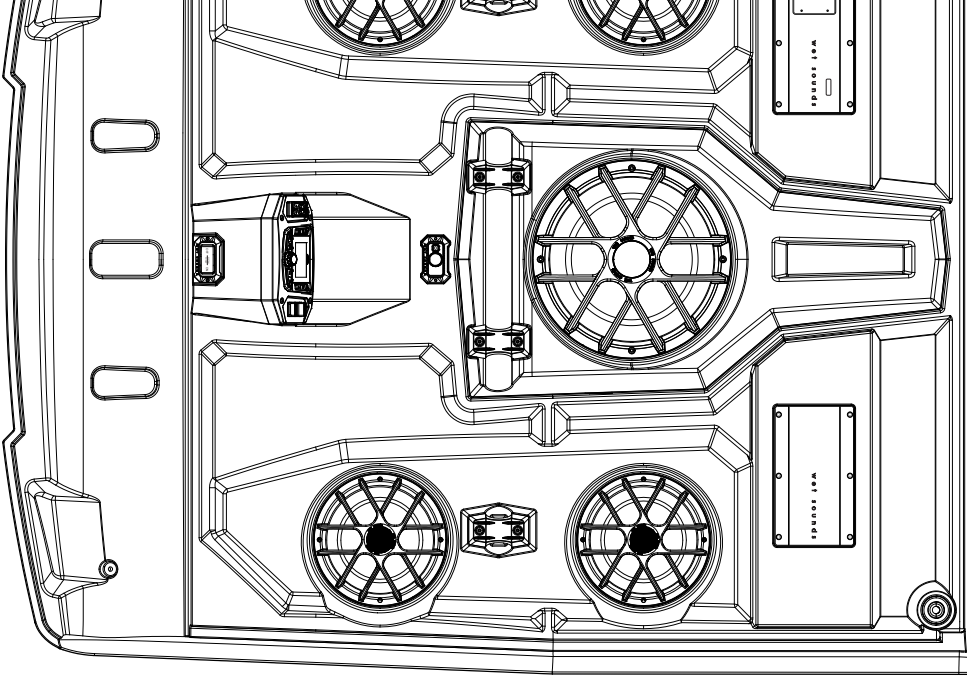

Take a few minutes to review the AR-5 installation guide

The AR-5 Ranger Crew is designed as a quick plug and play install. To ensure proper installation and your safety, please follow the tips mentioned below and the installation instructions provided.

Installation prep:

- A large flat open work area is recommended during installation.
- Make sure the vehicle is parked and secured in place.
- Disconnect the battery before working on the vehicle.
- Have a minimum of 4-6 people to help lift the roof.

Tools needed on hand:

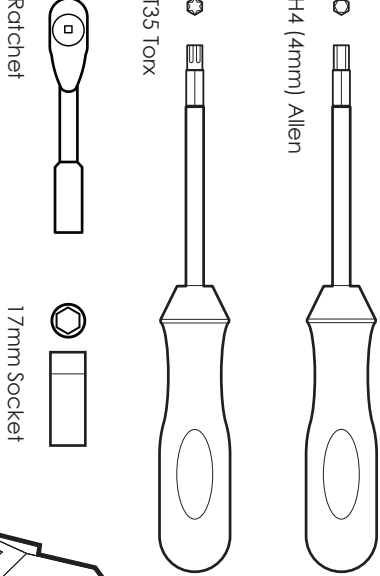

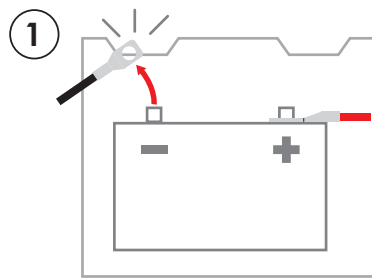

For safety reasons, we recommend disconnecting the battery before starting the installation.

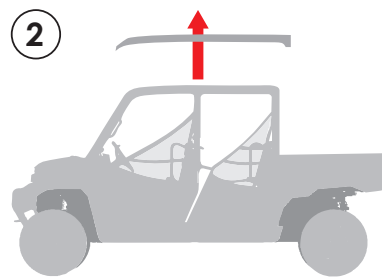

Remove any existing roof or roof rail accessories from the vehicle.

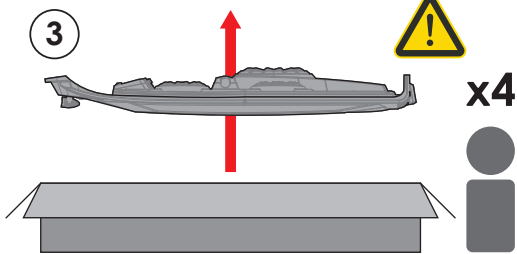

Lift the AR-5 Ranger Crew out of the box using four to six people.

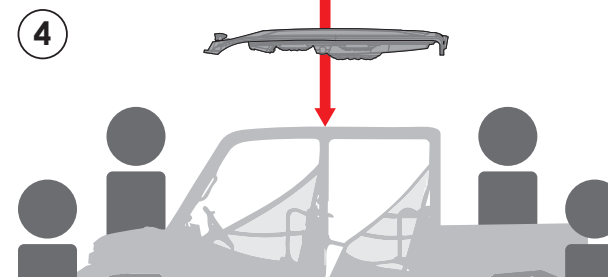

Carry the roof carefully to the vehicle and place it on the RANGER® roof rails.

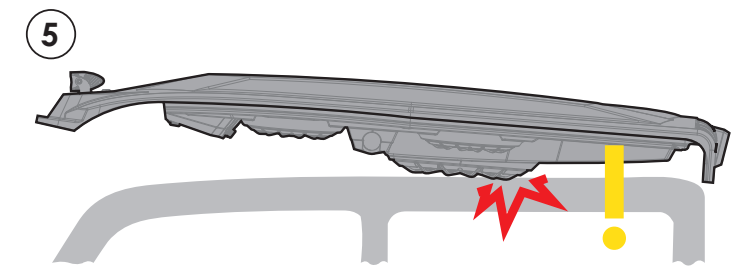

Be careful not to bump the speaker grilles while lifting the roof over the rails.

Included Hardware:

(4) Zip Ties



(4) Roof Clamps



(6) Short M6 Torx Screw



(8) M5 Button Head Screw



(2) M6 Flange Locknut

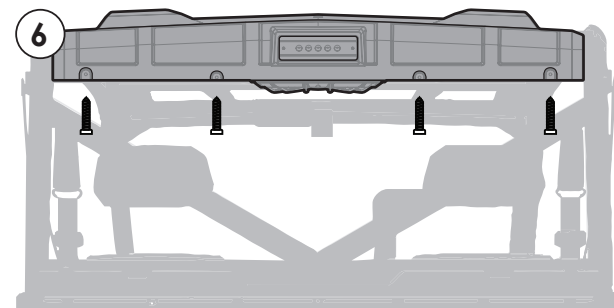

Fasten the back of the roof with the (4) M6 Torx screws provided.

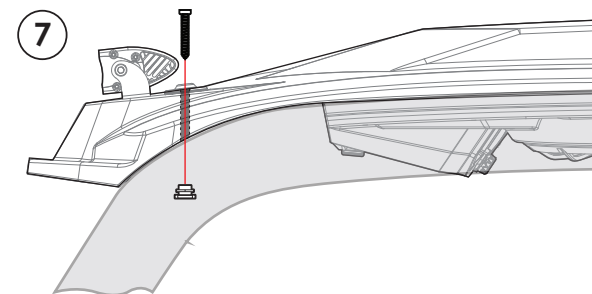

Use (2) M6 Torx screws and (2) M6 flange locknuts to fasten the front of the roof. Do not overtighten the screws.

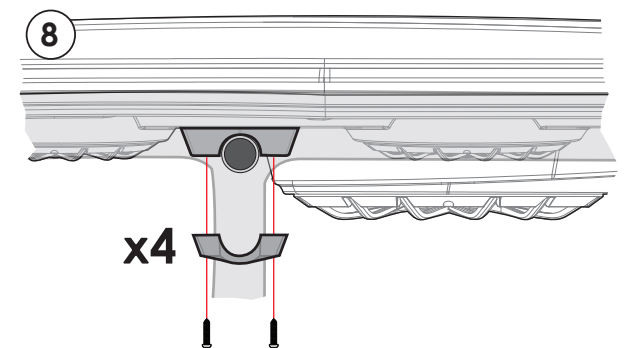

Attach the (4) center clamps with the (8) M5 screws provided to secure the roof to the center roof rail.

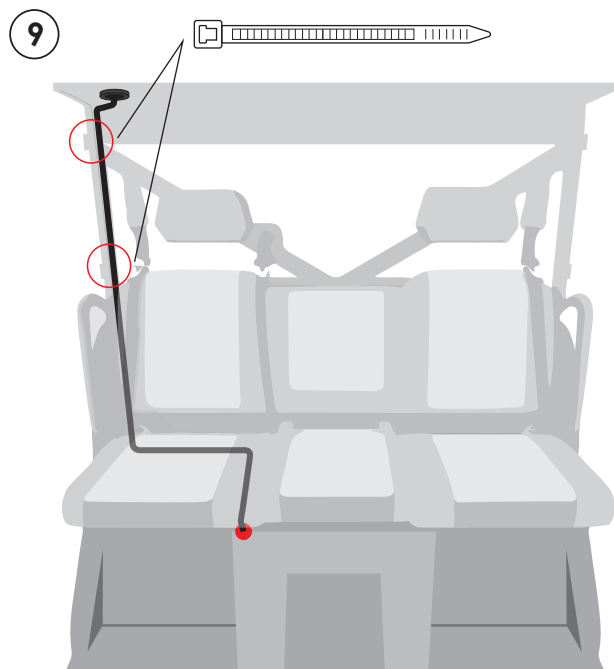

Secure the wiring harness to the post by using (2) zip ties near the locations marked above.

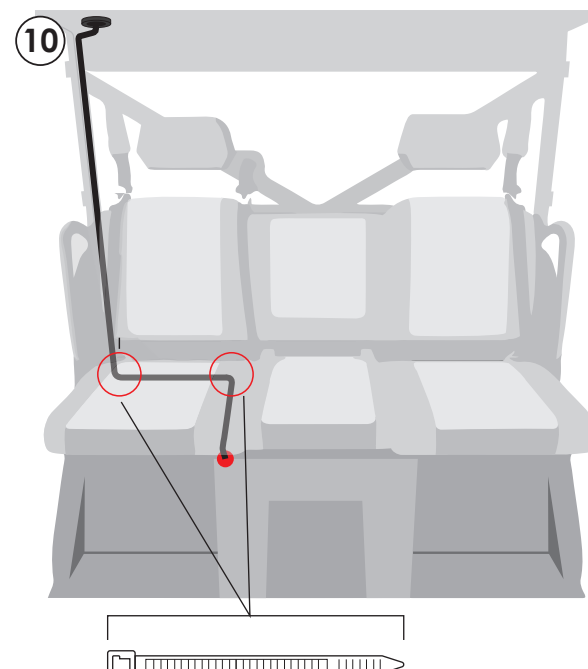

Wire the harness towards the battery and secure it to avoid it touching hot or moving parts. Extra (2) zip ties are included if needed.

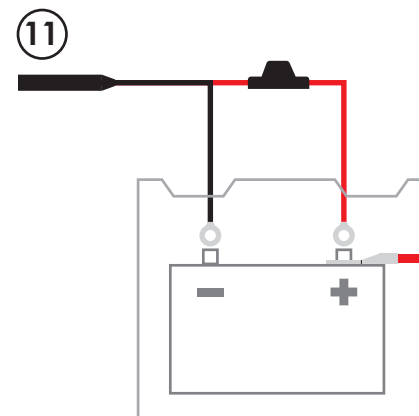

Connect the red wire to the positive battery terminal. Followed by the black wire to the negative terminal.

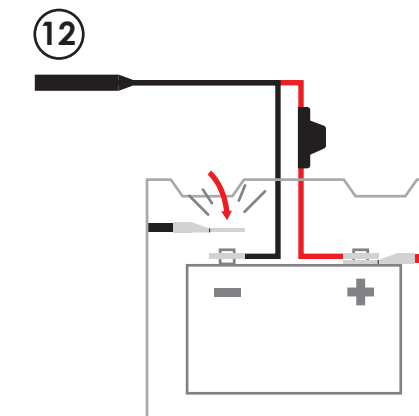

Fully reconnect the battery after the roof harness has been connected.

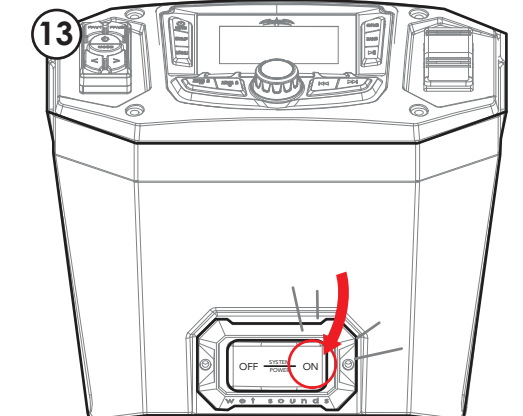

Flip the system power on and enjoy Wet Sounds high performance audio.

Thank you for choosing this Wet Sounds™ product!

If you have any questions or concerns, please contact a certified Wet Sounds dealer. You may also contact Wet Sounds technical support by dialing 1-877-WET-SPKR (1-877-938-7757).